

The Power

O.S.Engine Full Line-Up

2000-2001

AIRCRAFT/HELICOPTER /CAR & BUGGY /MARINE
GENUINE PARTS/LIVE STEAM LOCOMOTIVE

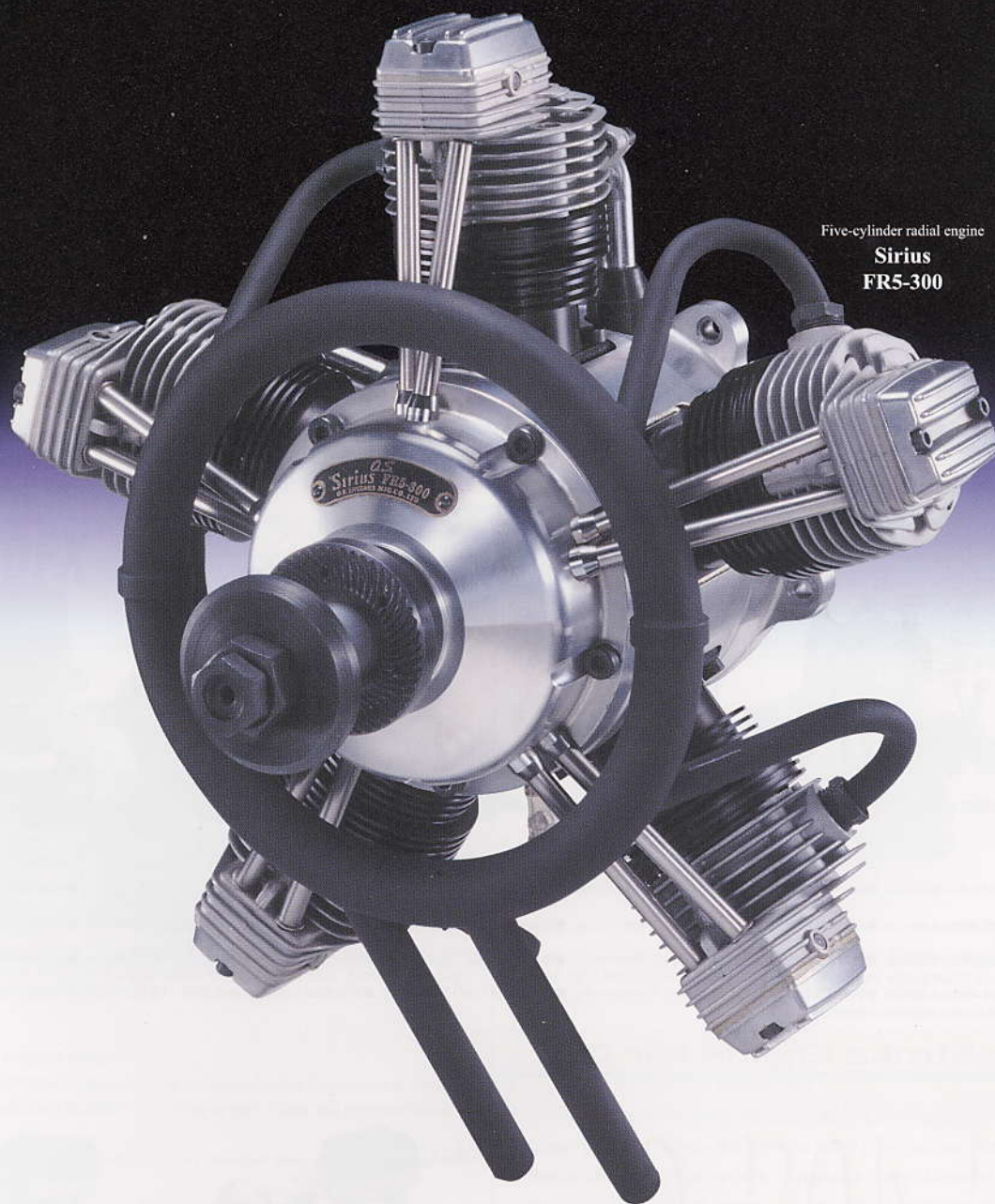

Five-cylinder radial engine

Sirius
FR5-300

O.S. ENGINES MFG.CO.,LTD.

Power, quality and muscle for every modeling application

! What's New?

Single-Cylinder Four-Stroke Engine

FS-70SII

"The Basic" Updated version of the very popular FS-70S

- Displacement 11.50cc/0.702cu.in. ● Bore 25.8mm/1.016in. ● Stroke 22.0mm/0.866in.
 - Output 1.1ps/11,000r.p.m. ● Practical r.p.m. Range 2,000~12,000r.p.m.
 - Weight 580g/20.4oz.
- F-4020 Silencer and Type F glowplug supplied as standard

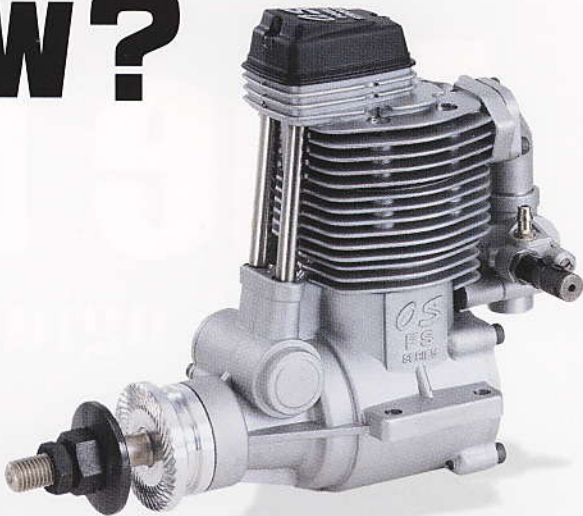

Two-Stroke Engine For Aircraft

MAX-15CV-A

Airplane version of the 15CV Series

- Displacement 2.49cc/0.152cu.in. ● Bore 15.2mm/0.598in. ● Stroke 13.7mm/0.539in.
 - Output 0.5ps/18,000r.p.m. ● Practical r.p.m. Range 2,500~19,000r.p.m.
 - Weight 170g/5.99oz.
- B73 Silencer and Type A3 glowplug supplied as standard

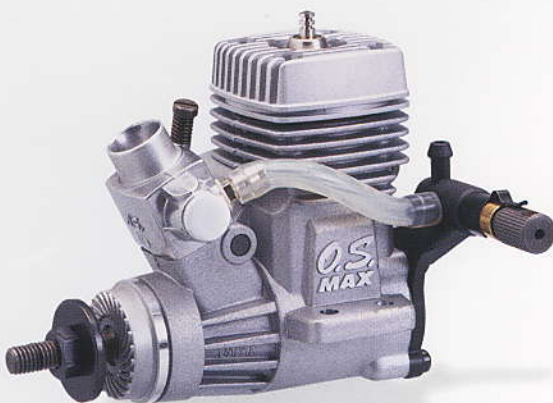

Control-Line Engines

MAX-LA-S SERIES

Control line version of the LA Series



- | | | | |
|---|---|---|--|
| MAX-46LA-S | MAX-40LA-S | MAX-25LA-S | MAX-15LA-S |
| ● Displacement 7.64cc/0.467cu.in. ● Bore 23.0mm/0.906in. ● Stroke 18.4mm/0.724in. ● Output 1.2ps/15,000r.p.m. ● Practical r.p.m. Range 2,000~16,000r.p.m. ● Weight 263.5g/9.28oz. | ● Displacement 6.49cc/0.396cu.in. ● Bore 21.2mm/0.834in. ● Stroke 18.4mm/0.724in. ● Output 1.0ps/15,000r.p.m. ● Practical r.p.m. Range 2,000~16,000r.p.m. ● Weight 267.5g/9.43oz. | ● Displacement 4.07cc/0.249cu.in. ● Bore 18.0mm/0.702in. ● Stroke 16.0mm/0.630in. ● Output 0.6ps/15,000r.p.m. ● Practical r.p.m. Range 2,000~16,000r.p.m. ● Weight 185.5g/6.54oz. | ● Displacement 2.49cc/0.152cu.in. ● Bore 15.2mm/0.598in. ● Stroke 13.7mm/0.539in. ● Output 0.41ps/17,000r.p.m. ● Practical r.p.m. Range 2,500~18,000r.p.m. ● Weight 129.5g/4.56oz. |
- Silencer and Type A3 glowplug supplied as standard

Four-Stroke Engine For Car

FS-40S-C

40 size 4 stroke engine designed for car

FS-40S-CX



- Displacement 6.49cc/0.396cu.in. ● Bore 21.2mm/0.835in. ● Stroke 18.4mm/0.724in.
- Output 0.9ps/17,500r.p.m. ● Practical r.p.m. Range 3,000~21,000r.p.m.
- Weight 323.5g/11.41oz (407g/14.35oz) ()—FS-40S-CX

MAX-50SX-HRING

(Code No.15500) For sports & scale models

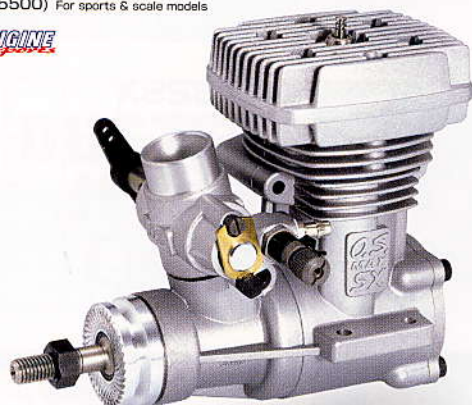

This is a high performance engine developed expressly for F3C M class helicopter competition utilizing .50 cubic inch engines. The engine comes equipped with the O.S.No.8 glow plug and special machined drive washer for helicopter use.

Features

- The engine uses the same mounting hole spacing as the O.S.46FX-H making the two engines interchangeable.
- Dual throttle levers for more positive throttle control.
- Available as optional equipment is an In-Flight control Needle Valve.(NO 71705000)

Specifications

Displacement	8.17cc/0.607cu.in	Output	2.0ps/16,000r.p.m.
Bore	24.0mm/0.945in.	Practical r.p.m.Range	2,000~18,000
Stroke	22.0mm/0.806in	Weight	514g/19.1oz.

MAX-160FX

For large sized sports & aerobatic models

(Code No.19260)

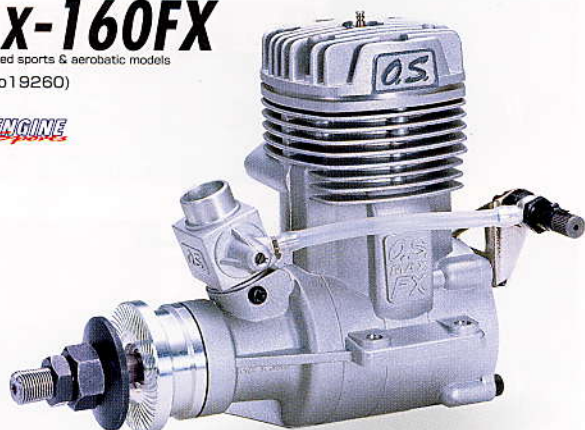

This is the largest member of the "FX Series" engines designed for large R/C sport and aerobatic type aircraft. Standard equipment includes the O.S. No.8 glowplug and No E-5010 muffler.

Features

- Low height and overall compact design.
- A remotely mounted needlevalve assembly that can be mounted either horizontally or vertically.
- Standard U.S. 3/8-24 crankshaft threads with locking propeller nuts and prop washers sized for APC propeller.
- Type 60F carburetor that has been proven to be easy to adjust ,have excellent response,and offer low fuel consumption.
- Modified exhaust port shape that results in higher torque at lower rpm.
- A large capacity E-5010 muffler that offers a lower sound level.
- The engines can be operated on fuels containing 0 to 25% nitromethane.

Specifications

Displacement	26.23cc/1.604cu.in	Output	3.7ps/9,000r.p.m.
Bore	33.6mm/1.3231in.	Practical r.p.m.Range	1,800~10,000r.p.m.
Stroke	29.6mm/1.165in	Weight	925g/32.6oz.

MAX-12CV-R

For 1/10 off-road buggy and scale cars

(Code No.11290)

(Code No.11292)



This engine has been designed specifically for 1/10 class R/C gas car racing. Standard equipment includes the O.S. heavy duty No102 air cleaner and No8 glowplug.

Features

- Hard chrome plated cylinder liner.
- Heavy duty 7075-T6 aluminum connecting rod.
- Highly durable 10mm i.d. rear ball bearing with a Nylon retainer.
- Blue anodized cylinder head.
- All major parts newly designed for competition use.

Specifications

Displacement	2.11cc/0.129cu.in	Output	1.0ps/31,000r.p.m.
Bore	14.0mm/0.551in.	Practical r.p.m.Range	4,000~36,000
Stroke	13.7mm/0.539in.	Weight	200g/7.05oz. (198.2g/6.99oz.)

()——12CV-R(P)

MAX-10LA

For small sized sport and trainer models

(Code No.11400)



This is the smallest member of the "LA Series" engines designed for small R/C aircraft and replaces the earlier 10FP. Standard equipment includes an O.S.A3 glowplug and O.S. 871 muffler.

Features

- Lighter and more compact than the 10FP.
- A newly designed carburetor with plastic body that provides better heat insulation.
- Longer crankshaft threads that allow the use of propellers with thicker hubs.
- Needlevalve mounted on top of the backplate in center of cylinder for easier installation in the model and less risk of damage in event of a hard landing or crash.

Specifications

Displacement	1.76cc/0.107cu.in	Output	0.27ps/17,000r.p.m.
Bore	13.44mm/0.529in.	Practical r.p.m.Range	2,500~18,000r.p.m.
Stroke	12.4mm/0.488in	Weight	112g/3.95oz.

TWO-STROKE ENGINES FOR FIXED-WING AIRCRAFT

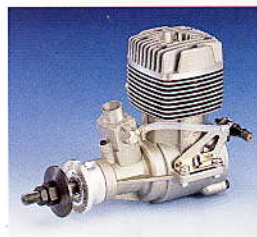

MAX-BGX-1 RING (RN)

For large sized aerobatic and scale models

Code No.19301

Displacement	34.97cc 2.13cu.in	Output	4.1ps/10,000r.p.m.
Bore	37.3mm 1.469in.	Practical r.p.m. Range	1,500~10,000r.p.m.
Stroke	32.0mm 1.260in.	Weight	1,340g 47.30oz.



MAX-160FXRING

For large sized sport and aerobatic models

Code No.19260

Displacement	26.23cc 1.604cu.in	Output	3.7ps/9,000r.p.m.
Bore	33.6mm 1.323in.	Practical r.p.m. Range	1,800~10,000r.p.m.
Stroke	29.6mm 1.165in.	Weight	925g 32.6oz.



MAX-140RX

Expressly for FAI F3A competition

Code No.19221

Displacement	23.0cc 1.404cu.in	Output	3.5ps/9,000r.p.m.
Bore	32.0mm 1.260in.	Practical r.p.m. Range	1,800~10,000r.p.m.
Stroke	28.6mm 1.126in.	Weight	830g 29.3oz.



MAX-140RX-FI

Expressly for FAI F3A competition

Code No.19230

Displacement	23.0cc 1.404cu.in	Output	3.5ps/9,000r.p.m.
Bore	32.0mm 1.260in.	Practical r.p.m. Range	1,800~10,000r.p.m.
Stroke	28.6mm 1.126in.	Weight	807g 28.5oz.



MAX-108FSRRING (BX-1) (RN)

For large sized scale sport models

Code No.19201

Displacement	17.83cc 1.088cu.in	Output	3.0ps/16,000r.p.m.
Bore	29.0mm 1.142in.	Practical r.p.m. Range	2,000~16,000r.p.m.
Stroke	27.0mm 1.063in.	Weight	750g 26.5oz.



MAX-91FXRING

For large sized scale sport models

Code No.19020

Displacement	14.95cc 0.912cu.in	Output	2.8ps/15,000r.p.m.
Bore	27.7mm 1.091in.	Practical r.p.m. Range	2,000~16,000r.p.m.
Stroke	24.8mm 0.976in.	Weight	550g 19.42oz.



MAX-61FX

For aerobatic, scale and sport models

Code No.17750

Displacement	9.95cc 0.607cu.in	Output	1.9ps/16,000r.p.m.
Bore	24.0mm 0.945in.	Practical r.p.m. Range	2,000~17,000r.p.m.
Stroke	22.0mm 0.866in.	Weight	550g 19.42oz.



MAX-46FX/MAX-40FX

For medium sized aerobatic, scale and sport models

Code No.15460/15450

Displacement	7.45/6.47cc 0.455/0.395cu.in	Output	1.62ps/16,000r.p.m. 1.36ps/16,000r.p.m.
Bore	22.0/20.5mm 0.866/0.807in.	Practical r.p.m. Range	2,000~17,000r.p.m.
Stroke	19.6mm 0.772in.	Weight	375g/386g 13.2oz./13.6oz.



MAX-32SX

For small sized aerobatic, scale and sport models

Code No.12970

Displacement	5.23cc 0.319cu.in	Output	1.2ps/18,000r.p.m.
Bore	19.5mm 0.768in.	Practical r.p.m. Range	2,000~22,000r.p.m.
Stroke	17.5mm 0.689in.	Weight	270g 9.53oz.



MAX-25FX

For small sized aerobatic, scale and sport models

Code No.12660

Displacement	4.07cc 0.248cu.in	Output	0.84ps/18,000r.p.m.
Bore	18.0mm 0.708in.	Practical r.p.m. Range	2,500~19,000r.p.m.
Stroke	16.0mm 0.630in.	Weight	248g 8.75oz.



MAX-65LA

For sport & trainer models

Code No.16500

Displacement	10.85cc 0.662cu.in	Output	1.7ps/16,000r.p.m.
Bore	24.0mm 0.945in.	Practical r.p.m. Range	2,000~16,000r.p.m.
Stroke	24.0mm 0.945in.	Weight	535g 18.87oz.



MAX-46LA

For medium sized sport and trainer models

Code No.13390

Displacement	7.64cc 0.467cu.in	Output	1.2ps/15,000r.p.m.
Bore	23.0mm 0.906in.	Practical r.p.m. Range	2,000~16,000r.p.m.
Stroke	18.4mm 0.724in.	Weight	272g 9.6oz.



MAX-40LA

For medium sized sport and trainer models

Code No.13380/13382(Natural Color)

Displacement	6.49cc 0.396cu.in	Output	1.0ps/15,000r.p.m.
Bore	21.2mm 0.834in.	Practical r.p.m. Range	2,000~16,000r.p.m.
Stroke	18.4mm 0.724in.	Weight	269g 9.5oz.



MAX-25LA

For small sized sport and trainer models

Code No.12350

Displacement	4.07cc 0.249cu.in	Output	0.6ps/15,000r.p.m.
Bore	18.0mm 0.709in.	Practical r.p.m. Range	2,000~16,000r.p.m.
Stroke	16.0mm 0.630in.	Weight	197g 6.95oz.



MAX-15LA

For small sized sport and trainer models

Code No.11530

Displacement	2.49cc 0.152cu.in	Output	0.41ps/17,000r.p.m.
Bore	15.2mm 0.598in.	Practical r.p.m. Range	2,500~18,000r.p.m.
Stroke	13.7mm 0.539in.	Weight	138g 4.87oz.

Due to updating and improvement, latest products may occasionally differ from those shown in the photos. All the specifications shown in this catalogue are subject to change without notice.



MAX-10LA

For small sized sport and trainer models

Code No.11400

Displacement	1.76cc 0.107cu.in	Output	0.27ps/17,000r.p.m.
Bore	13.44mm 0.529in.	Practical r.p.m.Range	2,500~18,000r.p.m.
Stroke	12.4mm 0.488in.	Weight	112g 3.95oz.

DUCTED-FAN JETMODEL ENGINES



MAX-91VR-DF/MAX-91VR-DF

For ducted-fan jet models

Code No.17501/17511

Displacement	14.76cc 0.900cu.in	Output	4.8ps/22,000r.p.m.
Bore	27.7mm 1.091in.	Practical r.p.m.Range	2,500~25,000r.p.m.
Stroke	24.5mm 0.965in.	Weight	707g/662g 24.96oz./23.37oz.



MAX-46VX-DF

For ducted-fan jet models

Code No.15392

Displacement	7.45cc 0.455cu.in	Output	2.5ps/23,000r.p.m.
Bore	22mm 0.866in.	Practical r.p.m.Range	2,500~28,000r.p.m.
Stroke	19.6mm 0.772in.	Weight	470g 16.58oz.

WANKEL ROTARY ENGINE



ROTARY ENGINE 49PI

For medium sized scale and sport models

Code No.31600

Displacement	4.97cc 0.303cu.in	Output	1.27ps/17,000r.p.m.
Bore		Practical r.p.m.Range	2,500~18,000r.p.m.
Stroke		Weight	335g 11.8oz.

HELICOPTER ENGINES



MAX-61SX-HRING"WC"

Expressly for FAI F3C competition

Code No.17930

Displacement	9.95cc 0.607cu.in	Output	2.2ps/16,000r.p.m.
Bore	24.0mm 0.945in.	Practical r.p.m.Range	2,000~18,000r.p.m.
Stroke	22.0mm 0.866in.	Weight	600g 21.2oz.



MAX-61SX-HGRING"WC"

Expressly for FAI F3C competition
For sports and scale models

Code No.17931

Displacement	9.95cc 0.607cu.in	Output	2.2ps/16,000r.p.m.
Bore	24.0mm 0.945in.	Practical r.p.m.Range	2,000~18,000r.p.m.
Stroke	22.0mm 0.866in.	Weight	553g 19.5oz.



MAX-61SX-HGLRING"WC"

Expressly for FAI F3C competition
For sports and scale models

Code No.17933

Displacement	9.95cc 0.607cu.in	Output	2.2ps/16,000r.p.m.
Bore	24.0mm 0.945in.	Practical r.p.m.Range	2,000~18,000r.p.m.
Stroke	22.0mm 0.866in.	Weight	682g 24.0oz.



MAX-61RX-HRING"WC"

Expressly for FAI F3C competition

Code No.17940

Displacement	9.95cc 0.607cu.in	Output	2.2ps/16,000r.p.m.
Bore	24.0mm 0.945in.	Practical r.p.m.Range	2,000~18,000r.p.m.
Stroke	22.0mm 0.866in.	Weight	597g 21.1oz.



MAX-61RX-HGRING"WC"

Expressly for FAI F3C competition
For scale and sports models

Code No.17941

Displacement	9.95cc 0.607cu.in	Output	2.2ps/16,000r.p.m.
Bore	24.0mm 0.945in.	Practical r.p.m.Range	2,000~18,000r.p.m.
Stroke	22.0mm 0.866in.	Weight	553g 19.5oz.



MAX-61RX-HGLRING"WC"

Expressly for FAI F3C competition
For scale and sports models

Code No.17942

Displacement	9.95cc 0.607cu.in	Output	2.2ps/16,000r.p.m.
Bore	24.0mm 0.945in.	Practical r.p.m.Range	2,000~18,000r.p.m.
Stroke	22.0mm 0.866in.	Weight	695g 24.5oz.



MAX-61LX-HRING

For sport and scale models

Code No.17950

Code No.17953(W/60H Low-Nitromethane type)

Displacement	9.95cc 0.607cu.in	Output	2.0ps/16,000r.p.m.
Bore	24.0mm 0.945in.	Practical r.p.m.Range	2,000~18,000r.p.m.
Stroke	22.0mm 0.866in.	Weight	541g 19.1oz.



MAX-61LX-HGLRING

For sport and scale models

Code No.17951

Displacement	9.95cc 0.607cu.in	Output	2.0ps/16,000r.p.m.
Bore	24.0mm 0.945in.	Practical r.p.m.Range	2,000~18,000r.p.m.
Stroke	22.0mm 0.866in.	Weight	645g 22.8oz.



MAX-50SX-HRING

For sport and scale models

Code No.15500

Displacement	8.17cc 0.499cu.in	Output	1.8ps/17,000r.p.m.
Bore	22.0mm 0.866in.	Practical r.p.m.Range	2,000~20,000r.p.m.
Stroke	21.5mm 0.847in.	Weight	413g 14.58oz.



MAX-46FX-HRING

For sport and scale models

Code No.15470

Displacement	7.45cc 0.455cu.in	Output	1.62ps/16,000r.p.m.
Bore	22.0mm 0.866in.	Practical r.p.m. Range	2,000~17,000r.p.m.
Stroke	19.6mm 0.772in.	Weight	385g 13.6oz.



MAX-32SX-H/SX-HRING

For sport and scale models

Code No.12950 / 12956

Displacement	5.23cc 0.319cu.in	Output	1.2ps/18,000r.p.m.
Bore	19.5mm 0.768in.	Practical r.p.m. Range	2,000~22,000r.p.m.
Stroke	17.5mm 0.689in.	Weight	290g/285g 10.23oz./10.06oz.

(Drive hub is optional extra)



MAX-32SX-HXRING

For sport and scale models W/Recoil Starter

Code No.12960

Displacement	5.23cc 0.319cu.in	Output	1.15ps/17,000r.p.m.
Bore	19.5mm 0.768in.	Practical r.p.m. Range	2,000~21,000r.p.m.
Stroke	17.5mm 0.689in.	Weight	387g 13.66oz.

(Drive hub is optional extra)

SINGLE-CYLINDER FOUR-STROKE ENGINES



FS-120S-SP O.S. SUPER CHARGER

Expressly for FAI F3A competition Supercharged.

Code No.35522

Displacement	19.96cc 1.218cu.in	Output	2.5ps/10,000r.p.m.
Bore	30.4mm 1.197in.	Practical r.p.m. Range	2,000~11,000r.p.m.
Stroke	27.5mm 1.085in.	Weight	1,030g 36.36oz.



FS-120SIII

For aerobatic, scale and sport models

Code No.35540

Displacement	19.96cc 1.218cu.in	Output	2.1ps/12,000r.p.m.
Bore	30.4mm 1.197in.	Practical r.p.m. Range	2,000~12,000r.p.m.
Stroke	27.5mm 1.083in.	Weight	920g 32.5oz.



FS-120S-E

For scale and sport models

Code No.35530

Displacement	19.96cc 1.218cu.in	Output	1.9ps/11,000r.p.m.
Bore	30.4mm 1.197in.	Practical r.p.m. Range	2,000~11,000r.p.m.
Stroke	27.5mm 1.083in.	Weight	864g 30.5oz.



FS-91SII-P

For aerobatic, scale and sport models

Code No.35910

Displacement	14.95cc 0.912cu.in	Output	1.6ps/11,000r.p.m.
Bore	27.7mm 1.091in.	Practical r.p.m. Range	2,000~12,000r.p.m.
Stroke	24.8mm 0.976in.	Weight	650g 23.0oz.



FS-91SII

For aerobatic, scale and sport models

Code No.35920

Displacement	14.95cc 0.912cu.in	Output	1.6ps/11,000r.p.m.
Bore	27.7mm 1.091in.	Practical r.p.m. Range	2,000~12,000r.p.m.
Stroke	24.8mm 0.976in.	Weight	640g 22.6oz.



FS-70SII

For aerobatic, scale and sport models

Code No.34700

Displacement	11.50cc 0.702cu.in	Output	1.1ps/11,000r.p.m.
Bore	25.8mm 1.016in.	Practical r.p.m. Range	2,000~12,000r.p.m.
Stroke	22.0mm 0.866in.	Weight	580g 20.4oz.



FS-52S

For scale and sport models

Code No.34200

Displacement	8.56cc 0.523cu.in	Output	0.9ps/12,000r.p.m.
Bore	23.0mm 0.906in.	Practical r.p.m. Range	2,300~13,000r.p.m.
Stroke	20.6mm 0.811in.	Weight	402g 14.19oz.



FS-40S

For scale and sport models

Code No.35220

Displacement	6.49cc 0.396cu.in	Output	0.65ps/12,000r.p.m.
Bore	21.2mm 0.835in.	Practical r.p.m. Range	2,200~12,000r.p.m.
Stroke	18.4mm 0.724in.	Weight	355g 12.5oz.



FS-26S

For scale and sport models

Code No.34100

Displacement	4.41cc 0.269cu.in	Output	0.41ps/11,000r.p.m.
Bore	18.5mm 0.728in.	Practical r.p.m. Range	2,200~12,000r.p.m.
Stroke	16.4mm 0.646in.	Weight	268g 9.45oz.

TWIN&MULTI-CYLINDER FOUR-STROKE ENGINES



FR5-300(Sirius)

Five-cylinder radial engine

For large sized scale models

Code No.37000

Displacement	9.95cc x 5 0.607cu.in x 5	Output	—
Bore	24.0mm 0.945in.	Practical r.p.m. Range	1,800~8,500r.p.m.
Stroke	22.0mm 0.866in.	Weight	2,670g 94.3oz.



FF-320(Pegasus)

Horizontally-opposed four-cylinder

For large sized scale models

Code No.36410

Displacement	13.26cc x 4 0.809cu.in x 4	Output	—
Bore	27.7mm 1.091in.	Practical r.p.m. Range	1,800~8,500r.p.m.
Stroke	22.0mm 0.866in.	Weight	2,190g 77.3oz.



FT-300 (Super Gemini-300)

Horizontally-opposed twin-cylinder
For large sized scale models

Code No.36210

Displacement	24.38cc x 2 1.488cu.inx2	Output	
Bore	33.6mm 1.323in.	Practical r.p.m.Range	1,800~9,000r.p.m.
Stroke	27.5mm 1.083in.	Weight	1,828g 64.5oz.



FT-160 (Gemini-160)

Horizontally-opposed twin-cylinder
For scale & sport models

Code No.36100

Displacement	13.26cc x 2 0.809cu.inx2	Output	
Bore	27.7mm 1.091in.	Practical r.p.m.Range	2,000~10,000r.p.m.
Stroke	22.0mm 0.866in.	Weight	1,100g 38.8oz.



FT-120 II (Gemini II)

Horizontally-opposed twin-cylinder
For scale & sport models

Code No.36300

Displacement	9.95cc x 2 0.607cu.inx2	Output	
Bore	24.0mm 0.945in.	Practical r.p.m.Range	2,000~10,000r.p.m.
Stroke	22.0mm 0.866in.	Weight	1,090g 38.4oz.

CAR & BUGGY ENGINES



PHOTO : 21RZ-V99b(P)

MAX-21RZ-V99b/21RZ-V99b(P)

Expressly for 1/8 off-road buggy competition

Code No.13844/13845

Displacement	3.46cc 0.211cu.in	Output	2.4ps/30,000r.p.m.
Bore	16.6mm 0.654in.	Practical r.p.m.Range	3,000~40,000r.p.m.
Stroke	16.0mm 0.630in.	Weight	332g/335g 11.7oz./11.82oz.



MAX-21RZ-R(P)

Expressly for 1/8 track-racing competition

Code No.13830

Displacement	3.46cc 0.211cu.in	Output	2.4ps/32,000r.p.m.
Bore	16.6mm 0.654in.	Practical r.p.m.Range	3,000~40,000r.p.m.
Stroke	16.0mm 0.630in.	Weight	307g 10.84oz.



PHOTO : 21RG

MAX-21RG/21RG(P)

For 1/8 off-road buggy events

Code No.13610/13611

Displacement	3.46cc 0.211cu.in	Output	1.9ps/30,000r.p.m.
Bore	16.6mm 0.654in.	Practical r.p.m.Range	3,000~35,000r.p.m.
Stroke	16.0mm 0.630in.	Weight	325g 11.47oz.



PHOTO : 21RG-X(P)

MAX-21RG-X/21RG(P)-X

For 1/8 off-road buggy events

Code No.13614/13612

Displacement	3.46cc 0.211cu.in	Output	1.9ps/30,000r.p.m.
Bore	16.6mm 0.654in.	Practical r.p.m.Range	3,000~35,000r.p.m.
Stroke	16.0mm 0.630in.	Weight	397.5g 14.03oz.



PHOTO : FS-26S-C

FS-26S-C/CX

4 STROKE ENGINE
For 1/10 class scale cars

Code No.34141/34150

Displacement	4.41cc 0.269cu.in	Output	0.5ps/17,000r.p.m.
Bore	18.5mm 0.728in.	Practical r.p.m.Range	2,000~22,000r.p.m.
Stroke	16.4mm 0.648in.	Weight	242.5g/308g 8.56oz./10.67oz.



MAX-15RX

Expressly 1/10 track-racing competition

Code No.11500

Displacement	2.49cc 0.152cu.in	Output	1.2ps/28,000r.p.m.
Bore	15.0mm 0.591in.	Practical r.p.m.Range	3,000~33,000r.p.m.
Stroke	14.1mm 0.555in.	Weight	240g 8.47oz.



PHOTO : 15LD

MAX-15LD/15LD(T)

W/E-1000Silencer
For 1/10 scale cars Exclusive design

Code No.11540/11545

Displacement	2.49cc 0.152cu.in	Output	0.68ps/29,000r.p.m.
Bore	15.2mm 0.598in.	Practical r.p.m.Range	3,000~30,000r.p.m.
Stroke	13.7mm 0.539in.	Weight	273g 9.64oz.



PHOTO : 15LD-X

MAX-15LD-X/15LD-X(T)

W/E-1000Silencer
As 15LD plus Recoil Starter

Code No.11550/11555

Displacement	2.49cc 0.152cu.in	Output	0.68ps/29,000r.p.m.
Bore	15.2mm 0.598in.	Practical r.p.m.Range	3,000~30,000r.p.m.
Stroke	13.7mm 0.539in.	Weight	336g 11.86oz.



PHOTO : 15CV

MAX-15CV/15CV-X

For 1/10 off-road buggy and scale cars

Code No.11522/11523

Displacement	2.49cc 0.152cu.in	Output	0.68ps/29,000r.p.m.
Bore	15.2mm 0.598in.	Practical r.p.m.Range	3,000~30,000r.p.m.
Stroke	13.7mm 0.539in.	Weight	208g/266g 7.27oz./9.32oz.



MAX-15CV-X

For 1/10 off-road buggy and scale cars

Code No.11520

Displacement	2.49cc 0.152cu.in	Output	0.68ps/29,000r.p.m.
Bore	15.2mm 0.598in.	Practical r.p.m.Range	3,000~30,000r.p.m.
Stroke	13.7mm 0.539in.	Weight	208g/266g 7.27oz./9.32oz.



MAX-15CVHyper/15CV-XHyper

For 1/10 off-road buggy and scale cars
Supplied With 10A automatic Carburetor

Code No.11607/11608

Displacement	2.49cc 0.152cu.in	Output	0.68ps/29,000r.p.m.
Bore	15.2mm 0.598in.	Practical r.p.m.Range	3,000~30,000r.p.m.
Stroke	13.7mm 0.539in.	Weight	190g/248g 6.70oz./8.75oz.



PHOTO : 12LD

MAX-12LD/12LD(T)

W/E-1000Silencer
For 1/10 scale cars Exclusive design

Code No.11170/11171

Displacement	2.11cc 0.129cu.in	Output	0.56ps/29,000r.p.m.
Bore	14.0mm 0.551in.	Practical r.p.m.Range	3,000~30,000r.p.m.
Stroke	13.7mm 0.539in.	Weight	273.2g 9.46oz.

Due to updating and improvement, latest products may occasionally differ from those shown in the photos. All the specifications shown in this catalogue are subject to change without notice.



PHOTO: 12LD-X

MAX-12LD-X/12LD-X(T)

W/E-1000Silencer
For 1/10 scale cars As 12LD plus Recoil Starter

Code No.11180/11183

Displacement	2.11cc 0.129cu.in	Output	0.56ps/29,000r.p.m.
Bore	14.0mm 0.551in.	Practical r.p.m.Range	3,000~30,000r.p.m.
Stroke	13.7mm 0.539in.	Weight	335.7g 11.85oz.

MARINE ENGINES



MAX-12CV-R

For 1/10 off-road buggy and scale cars
Supplied With 10A automatic Carburettor

Code No.11290

Code No.11292

Displacement	2.11cc 0.129cu.in	Output	1.0ps/31,000r.p.m.
Bore	14.0mm 0.551in.	Practical r.p.m.Range	4,000~36,000r.p.m.
Stroke	13.7mm 0.539in.	Weight	200g 7.05oz.



MAX-81VR-MABC

Expressly for power-boat racing

Code No.18101

Displacement	13.01cc 0.794cu.in	Output	4.2ps/22,000r.p.m.
Bore	26.0mm 1.024in.	Practical r.p.m.Range	2,500~25,000r.p.m.
Stroke	24.5mm 0.965in.	Weight	914g 32.3oz.



MAX-12CV-R(P)

For 1/10 off-road buggy and scale cars
Supplied With 10A automatic Carburettor

Code No.11293

Displacement	2.11cc 0.129cu.in	Output	1.0ps/31,000r.p.m.
Bore	14.0mm 0.551in.	Practical r.p.m.Range	4,000~36,000r.p.m.
Stroke	13.7mm 0.539in.	Weight	198.2g 6.99oz.



MAX-65VR-MABC/MAX-61VR-MABC

Expressly for power-boat racing

Code No.17220/17171

Displacement	10.63/9.95cc 0.649/0.607cu.in	Output	3.0ps/22,000r.p.m. 2.8ps/22,000r.p.m.
Bore	24.8/24.0mm 0.976/0.945in.	Practical r.p.m.Range	2,500~25,000r.p.m.
Stroke	22.0mm 0.866in.	Weight	913g/910g 32.23oz./32.12oz.



MAX-12CVHyper/MAX-12CV-XHyper

For 1/10 off-road buggy and scale cars
Supplied With 10A automatic Carburettor

Code No.11273/11274

Displacement	2.11cc 0.129cu.in	Output	0.56ps/29,000r.p.m.
Bore	14.0mm 0.551in.	Practical r.p.m.Range	3,000~30,000r.p.m.
Stroke	13.7mm 0.539in.	Weight	190g/248g 6.70oz./8.75oz.



(Photo shown including full options)

MAX-46VX-M/vx-M(ST)

Expressly for power-boat racing

Code No.15390/15391

Displacement	7.45cc 0.455cu.in	Output	2.5ps/23,000r.p.m.
Bore	22.0mm 0.866in.	Practical r.p.m.Range	2,500~28,000r.p.m.
Stroke	19.6mm 0.772in.	Weight	445g 15.7oz.



PHOTO: 12CV

MAX-12CV/12CV-X (GrandPrix Red)

For 1/10 off-road buggy and scale cars

Code No.11233/11234

Displacement	2.11cc 0.129cu.in	Output	0.56ps/29,000r.p.m.
Bore	14.0mm 0.551in.	Practical r.p.m.Range	3,000~30,000r.p.m.
Stroke	13.7mm 0.539in.	Weight	231g/289g 8.14oz./10.21oz.



MAX-32SX-MX

For scale & sport models

Code No.12980

Displacement	5.23cc 0.319cu.in	Output	1.1ps/17,000r.p.m.
Bore	19.5mm 0.768in.	Practical r.p.m.Range	2,500~21,000r.p.m.
Stroke	17.5mm 0.689in.	Weight	423g 14.92oz.



PHOTO: 12CV

MAX-12CV/12CV-X (Circuit gray)

For 1/10 off-road buggy and scale cars

Code No.11235/11236

Displacement	2.11cc 0.129cu.in	Output	0.56ps/29,000r.p.m.
Bore	14.0mm 0.551in.	Practical r.p.m.Range	3,000~30,000r.p.m.
Stroke	13.7mm 0.539in.	Weight	231g/289g 8.14oz./10.21oz.



MAX-21RZ-M

Expressly for power-boat racing

Code No.13850

Displacement	3.46cc 0.211cu.in	Output	2.4ps/32,000r.p.m.
Bore	16.6mm 0.654in.	Practical r.p.m.Range	3,000~40,000r.p.m.
Stroke	16.0mm 0.630in.	Weight	284g 10.03oz.



PHOTO: 12CV

MAX-12CV/12CV-X (Midnight blue)

For 1/10 off-road buggy and scale cars

Code No.11254/11255

Displacement	2.11cc 0.129cu.in	Output	0.56ps/29,000r.p.m.
Bore	14.0mm 0.551in.	Practical r.p.m.Range	3,000~30,000r.p.m.
Stroke	13.7mm 0.539in.	Weight	231g/289g 8.14oz./10.21oz.



MAX-21XM

For 21class outboard

Code No.13940

Displacement	3.46cc 0.211cu.in	Output	1.3ps/25,000r.p.m.
Bore	16.6mm 0.654in.	Practical r.p.m.Range	3,000~25,000r.p.m.
Stroke	16.0mm 0.630in.	Weight	670g 23.6oz.



PHOTO: 15CV-MX

MAX-15CV-MX/15CV-M

For scale and sport models

Code No.11526/11525

Displacement	2.49cc 0.152cu.in	Output	0.6ps/22,000r.p.m.
Bore	15.2mm 0.598in.	Practical r.p.m.Range	3,000~25,000r.p.m.
Stroke	13.7mm 0.539in.	Weight	225g/167g 7.94oz./5.89oz.

TWO-STROKE ENGINES FOR FIXED-WING AIRCRAFT

Items	A	B	C	D	E	F	G	H	J	S
MAX-BGX-1 RING	74	32	129.5	85	142.5	99	60.5	83	111	UNF3/8-24
MAX-160FX RING	64	30	115.5	74	123.2	80	51.5	65	96.7	//
MAX-140RX	58	25	117.2	70	118	78	48.4	65	94	UNF5/16-24
MAX-140RX FI	58	25	113	70	118	78	48.4	65	94	//
MAX-108FSR RING<BX-1>	58	30	121	70	119	75	48	60	95	UNF3/8-24
MAX-91FX RING	52	25	103.3	61	103	66.5	43	54	81.5	UNF5/16-24
MAX-61FX	52	25	106.6	61	100.5	66.5	43	54	79	//
MAX-46FX / 40FX	44	17.5	88	51	88	60.5	35	52	70	UNF1/4-28
MAX-32SX	38	15	77.8	45	73	53	30.3	45.5	56	//
MAX-25FX	38	15	77.8	46	75.5	53	30	45.5	60	//
MAX-65LA	52	25	99.8	62	107	61.2	42	48.7	85.4	UNF5/16-24
MAX-46LA / 40LA	40.5	17.5	81.5	48	85	51.2	32	42.5	69	UNF1/4-28
MAX-25LA	36	14	72.8	44	74.5	46.5	29	39	60	//
MAX-15CV-A	31.4	11	65.5	39	62.5	41	25	35.5	49	M5
MAX-15LA	33	14.4	63.7	40	61	39.5	24.8	30.8	48.5	//
MAX-10LA	31.4	11	61.5	38.6	55.8	38.7	23	33.2	42.8	//

DUCTED-FAN JET MODEL ENGINES

Items	A	B	C	D	E	F	G	H	J	S
MAX-91VR-DF	52	25	133.5	61	109.5	66	43.5	53.5	87.5	UNF5/16-24
MAX-91VR-DF <small>Round Cylinder head version</small>	52	25	133.5	61	103.3	66	43.5	53.5	81.5	//
MAX-46VX-DF	45	21	115.5	53	90.5	55.6	37	45.1	72.3	UNF1/4-28

HELICOPTER ENGINES

Items	A	B	C	D	E	F	G	H	J	S
MAX-61SX-H RING"WC"	52	25	93	61	100.5	65	42.6	52.5	79	UNF5/16-24
MAX-61SX-HG RING"WC"	52	25	80.5	61	100.5	52.5	42.6	40	79	UNF1/4-28
MAX-61SX-HGL RING"WC"	52	25	80.5	61	106.5	52.5	42.6	40	85	//
MAX-61RX-H RING"WC"	52	25	93	61	100.5	65	42.6	52.5	79	UNF5/16-24
MAX-61RX-HG RING"WC"	52	25	80.5	61	100.5	52.5	42.6	40	79	UNF1/4-28
MAX-61RX-HGL RING"WC"	52	25	80.5	61	106.5	52.5	42.6	40	85	//
MAX-61LX-H RING	52	25	80.5	61	100.5	52.5	42.6	40	79	UNF5/16-24
MAX-61LX-HGL RING	52	25	83.8	61	104.3	55.8	42.6	43.3	82.8	//
MAX-50SX-H RING	44	17.5	85.8	52	89	61	36	52.3	70.5	UNF1/4-28
MAX-46FX-H RING	44	17.5	84.2	51	88	60.5	35	52	70	UNF5/16-24
MAX-32SX-H / SX-H RING	38	15	75	45	76	53	30.3	45.5	60.6	//
MAX-32SX-HX RING	38	15	94.5	45	76	53	30.3	45.5	60.6	//

SINGLE-CYLINDER FOUR-STROKE ENGINES

Items	A	B	C	D	E	F	G	H	J	S
FS-120S-SP	58	25	158.5	67	139	77	46	64.5	115	UNF5/16-24
FS-120S II	58	25	134.5	67	139.5	77	47	64.5	116	//
FS-120S-E	58	25	134	67	138.5	77	47	64.5	115	//
FS-91S II-P	52	25	122	60	123	66.5	42.6	54	101	//
FS-91S II	52	25	122.5	60	121	66.5	42.6	54	99	//
FS-70S II	50	21	113	59	116.5	66	40	55.5	96	//
FS-52S	44	17.5	101.5	51	101	59	34	49.3	83.5	UNF1/4-28
FS-40S	42	17.5	92.5	49	98	57	32.5	48.1	80.5	//
FS-26S	36	14	82	44	86.5	48.5	29	40	70	//

Dimensions (mm)

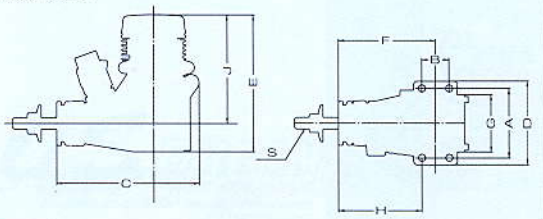

Dimensions (mm)

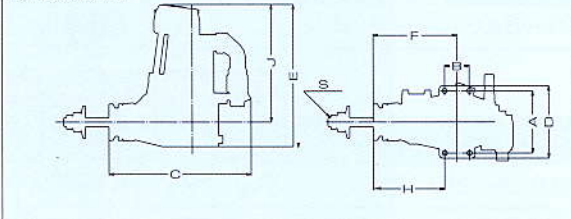

TWIN & MULTI-CYLINDER FOUR-STROKE ENGINES

Items	A	B	C	D	E	F	G	H	J	S
FR5-300<Sirius>	1122			234	158.5					UNF3/8-24
FF-320<Pegasus-320>	68	56.5	23.5	196	181.5	112.5	125.5	76	62	UNF5/16-24
FT-300<Super Gemini-300>	90	55	35	240	148	62	80	56	10	UNF3/8-24
FT-160<Gemini-160>	68	56.5	23.5	196	120	50.5	63.5	54		UNF5/16-24
FT-120 II<Gemini II>	68	56.5	23.5	196	120	50.5	63.5	54		//

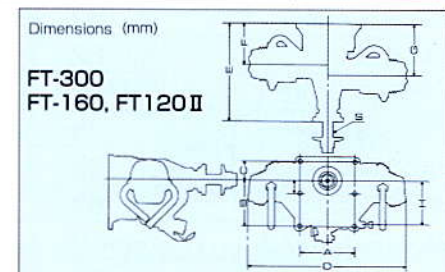
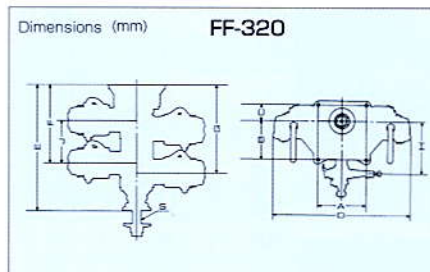
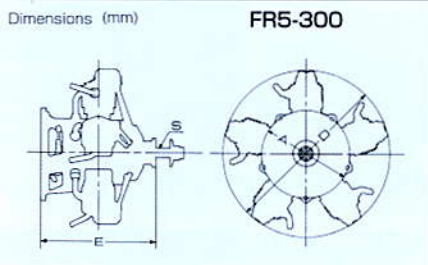

*Dimension A for FT-120 II, FT-160 and FF-320 is with motor mount fitted.

CAR & BUGGY ENGINES

Items	A	B	C	D	E	F	G	H	J	S
MAX-21RZ-V99b / MAX-21RZ-V99b(P)	37	21	65.6	45	101	44	30.6	33.5	86	UNF1/4-28
MAX-21RZ-R(P)	37	21	65.5	45	96.3	44	29.6	33.5	81.5	//
MAX-21RG / MAX-21RG(P)	37	21	65.6	45	95.8	44	29.6	33.5	80.7	//
MAX-21RG-X / MAX-21RG(P)-X	37	21	88.4	45	95.8	44	29.6	33.5	80.7	//
FS-40S-C	42	17.5	77.5	49	98	57	32.5	48.1	80.5	//
FS-40S-CX	42	17.5	89	49	98	57	32.5	48.1	80.5	//
FS-26S-C	36	14	57.8	43	84.6	39.8	29	32.8	70.4	//
FS-26S-CX	36	14	75	44	90.4	39.8	29	32.8	70.4	//
MAX-15RX	37	21	60	45	87.3	41.5	29	31	72.5	//
MAX-15CV	31.4	11	58.6	39	87.2	41	25	35.5	74.4	M5
MAX-15CV Hyper / 12CV Hyper	31.4	11	58.6	39	81.3	41	25	35.5	68.3	//
MAX-12CV-R / MAX-12CV-R(P)	31.4	11	58.6	39	83.7	41	25	35.5	70.9	//
MAX-15CV-X Hyper / 12CV-X Hyper	31.4	11	58.6	39	81.3	41	25	35.5	68.3	//
MAX-12CV	31.4	11	58.6	39	87.2	41	25	35.5	74.4	//
MAX-12CV-X	31.4	11	74.8	39	87.2	41		35.5	74.4	//

SUGGESTED PROPELLER SIZES

sted propeller sizes are given in the table. As the propeller diameter, pitch and blade area vary with and type of model, final propeller selection can be after practical experiment.

Reminder!



ever touch, or allow any object to come into contact with, the rotating propeller and do not touch over the engine when it is running.

TWO-STROKE ENGINES

DIA X PITCH

FP Series	Running-in	Trainer & Sport
10FP(RN)/FP-S(RN)	7x4	7x4~5
15FP(RN)/FP-S(RN)	8x4	7x5~6, 8x4~6
20FP(RN)/FP-S(RN)	9x4	9x4~5
25FP(RN)/FP-S(RN)	9x5	9x5~6
35FP(RN)/FP-S(RN)	10x6	10x5~6
40FP(RN)/FP-S(RN)	11x5	10x6.5, 10.5x6, 11x5
60FP(RN)	12x6	11x7~8, 12x6~7
LA Series	Running-in	Trainer & Sport
15LA	8x4	7x5~6, 8x4~5
25LA	9x5	9x5~6
40LA	11x5	10x6~7, 10.5x6, 11x5~6
46LA	11x6	11x6~7
65LA	12x6	12x7~8, 13x6~8
SX/FX Series	Sport	Aerobatic
25FX	9x5~6, 9.5x5, 10x5	9x6, 9.5x5
32SX	10x6, 10.5x5, 11x6	9x7~8, 10x6
40FX	10x6, 10.5x6, 11x6~7	
46FX	10.5x6, 11x6~8, 12x6~7	11x8~10, 12x7~9 (tuned silencer used)
61FX	12x6~8, 13x6~7	12x9~11 (tuned silencer used)
91FXRING	15x8, 16x6~8, 17x6 14x7 (3blade)	13x11~13, 14x10~11
108FSRRING(RN)(BX-1)	14x6~8, 15x6~8, 16x6 18x6	
140RX	スタント Aerobatic 15x14~16, 16x13~15	
BGX-1RING(RN)	18x10~12, 20x8~10	18x10~12, 20x8~10

FOUR-STROKE ENGINES

Single-cylinder	Sport & Aerobatic	Trainer & Sport
FS-26S	9x6~7	9x6~7, 10x6, 10.5x6 8x6 (3blade)
FS-40S	10x7~7.5, 11x6, 9x7 (3blade)	10x7, 10.5x6, 11x7, 12x5~6 10x7 (3blade)
FS-52S	10x9~10, 10.5x8~9 11x7~8	11x7~8, 12x6, 12.5x6
FS-70S	11x8~9, 12x7~8, 12.5x6	13.5x8, 14x7, 11x7 (3blade)
FS-91S/FS-91S II-P	11x11~12, 12x10~12, 13x9	13.5x8, 14x7, 15x6, 16x6 12x8 (3blade)
FS-120S-E	13x11~12, 14x10~11	15x8, 16x6~7, 18x5~6 14x7 (3blade), 15x8 (3blade)
FS-120S III	13x11~13, 14x10~11	15x8, 16x6~7, 18x5~6 14x7 (3blade), 15x8 (3blade)
FS-120S-SP	13.5x14~15, 14x13~14	
Twin & Multi-cylinder	Sport & Scale	
FT-120 II (Gemini II)	14x9~11, 15x8~10, 16x6, 18x6	
FT-160 (Gemini-160)	16x6~8, 18x6~8, 20x6	
FT-300 (Super Gemini-300)	18x10~14, 20x8~11, 22x8	
FF-320 (Pegasus)	18x10~14, 20x8~10, 22x8	
FR5-300 (Sirius)	18x10~14, 20x8~10, 22x8	

WANKEL ROTARY ENGINES

ROTARY ENGINE	Sport & Scale
ROTARY ENGINE 49PI	8x6, 9x5~6, 9.5x5, 10x5

O.S. ENGINE

GENUINE PARTS & ACCESSORIES

RADIAL MOTOR MOUNTS

For firewall type engine mounting, these sturdy precision-made aluminium alloy mounts are ready-drilled and tapped and are complete with screws, lock-washers and blind nuts.

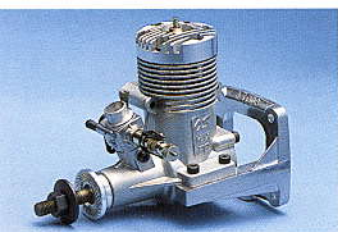

Code No.	Type of Engine
71909110	10FP-10LA
71909310	15FP-15LA
71909410	15CV-A-CZ
71908300	FS-26S
71908100	20-25FP-25LA
71908400	32F
71908410	25FX 32SX
71906200	35FP 40-46LA
71906000	FS-40S
71913000	FS-52S
71913100	40-46FX
71905200	65LA 61-91FX
71905000	FS-70S
71901100	FS-91S-91S II-P
71907000	108FSR (BX-1)
71904200	FS-120S III-120S-E
71920000	160FX

BOOSTER CABLE SETS



Booster cable sets are available for connection to an on-board battery for glowplug re-heat during idling and/or for simultaneously energizing the plugs of twin or multi-cylinder engines.

For single cylinder (72200110) **For twin cylinder** (72200090)

SPINNER NUTS

These machined alloy safety spinner nuts are available in all sizes for securing appropriate propellers and are smoothly shaped to guard against the risk of injury.



Code No.	Size	Type of Engine
20824005	M5	10FP-15LA-10LA
21524001	7/32"-32	15FP
23024008	1/4"-28	20-25 RE
23024009	1/4"-28 (L)	20-50 RE
45024000	5/16"-24	60FP-65LA 61-91FX

RADIAL MOTOR MOUNT ASSEMBLY FOR FS-120S-SP (71904300)



This 'soft' type engine mount was developed expressly for the supercharged O.S. FS-120S-SP engine. Its purpose is to reduce resonance resulting from engine vibration transmitted to the airframe. The resilience of the mount is adjustable, by means of locknuts, to balance power v. noise absorption.

BOOSTER TERMINAL KIT (72200130)



For helicopters and other models having enclosed engines, this kit enables the glowplug to be wired to a more conveniently located terminal on the aircraft.

BOOSTER TERMINAL KIT FOR "HIROBO SHUTTLE"



This version of the O.S. Booster Terminal kit is intended for the popular Hirobo 'Shuttle' helicopter. It enables the glowplug to be energized via a terminal at the rear of the Shuttle's main frame. Aluminium terminal base plates are supplied for both current and previous Shuttle models.

LONG PROPELLER NUT SETS



Where an extra thick propeller boss and/or spinner backplate leaves insufficient thread for a standard propnut, the use of these extended nut sets is recommended.

For 20-50, ROTARY (73101000) **For 60FP, 65LA, 61-91FX** (73101010)

PROPELLER LOCKNUT SETS

For four-stroke engines, an O.S. Safety Locknut assembly prevents the prop from flying off in the event of its loosening, due to detonation caused by lean running or overloading.



Code No.	Type of Engine
45810100	FS-40S
45810200 (For Spinner)	FS-52S
45910100	FS-70S-91S
45910200 (For Spinner)	FS-70S-91S
45510100	FS-120S SERIES
46110100	FS-120S SERIES
46110100	FT-120II-160
46210100	FT-240-300 FR5-300
46410100	FF-320

PROPELLER LOCKNUT SETS FOR TRUTURN SPINNERS

These have the same purpose as the Locknut sets previously listed, but are for use in conjunction with 'Truturn' type spinners.



Code No.	Size	Type of Engine
45810300	1/4"-M5	FS-52S
45910300	5/16"-M5	FS-70S-91S FS-120S SERIES
46110200	5/16"-M5(L)	FT-120II-160 FF-320
29310110	3/8"-M5(S)	BGX-1-160 FX
46210300	3/8"-M5(L)	FT-240-300 FR5-300

MARINE UNIVERSAL JOINTS

These heavy-duty universal-joint marine prop-shaft couplings are made of hardened steel and have a black rust-proofed finish.



Code No.	Type of Engine
21342000	10FP-M-MX (3.5mm)
22442009	20FP-M 21RZ-M 32SX-MX (4.0mm)
25343201	40-46VR-M (5.0mm)
25343108	46VX-M 40-46VR-M (4.5mm)
25343305	40-46VR-M (3/16")
27243109	61-81VR-M (5.0mm)
27243202	61-65VR-M (3/16")

REMOTE NEEDLE VALVE (28282000)



For Type 9B Carburettor

IN-FLIGHT CONTROL NEEDLE VALVE



(71703009)

For Type 86, 7L, 6H, 8H, 7DV, 7D
7G, 7F, 4BK, 4D, 4E Carburettor



(71705000)

For 60B, 40E Carburettor

MACHINE HEAD

O.S. SPEED



For 12CV

BLUE (72001110)
RED (72001100)
GOLD (21404000)



For 15CV

GOLD (21504200)
BLACK (21504100)



PROPELLER NUT SETS FOR TRUTURN SPINNERS (73101020)



This extended nut and washer set is intended for .20-.50 size engines when fitted with 'Truturn' spinners.

For 20~50, ROTARY

FLYWHEELS

O.S. precision-machined flywheels ensure superior dynamic balance. The following types are available to suit the engine sizes shown.



Code No.	Type	Type of Engine
71801040	N0.1D	10FP-M-MX
71802005	N0.2B	20FP-M
71802020	N0.2D	32SX-MX
71802030	N0.2E	21RZ-M
71802100	N0.2J	21XM
25342007	N0.4B	40-46VR-M
71804020	N0.4C	46VX-M
71805400	N0.7	61~81VR-M

MIXTURE CONTROL CARBURETTOR



60D(27983000)

For MAX-61SX-HRING "WC"
MAX-61RX-HRING "WC"



70B(27984000)

For MAX-140RX

These two high-precision O.S. carburetors have been designed to meet the exacting demands of top-level world Championship Class competition flying. The Type 60D is intended for the MAX-61SX-H and MAX-61RX-H 'WC' Series 10cc helicopter engines, while the Type 70B is for the powerful 23cc MAX-140RX and Class F3A aerobatics contests.

Both carburetors are equipped with a special mixture control valve, operated by its own servo, that is adjusted, initially, to provide optimum mixture strength, according to the varying requirements of the engine and which, thereafter, automatically readjusts itself to this pattern relative to throttle movement.

Employed in conjunction with an advanced R/C system (such as the Futaba PCM1024ZH/ZA Series) incorporating a mixture control function, the Type 60D will accommodate the full pattern of helicopter mixture strength variations, from idling, through the transition from take-off to hovering and on to high-speed flight. For 'fixed-wing' use, the Type 70B adopts 'acceleration' and 'deceleration' modes, which temporarily increases fuel supply for full-power acceleration and reduces fuel admission when the throttle is closed to avoid detonation or 'knocking'.

SUPER SILENCERS



O.S. Super Silencers incorporate a primary expansion box from which gases pass, multi-directionally, through a double-cone baffle into an intermediate chamber, before being reunited, via a single-cone baffle, in an exit chamber with adjustable angled outlet pipe. The combination of separate chambers for dealing with low and high frequency emissions provides excellent noise reduction with minimum power loss.

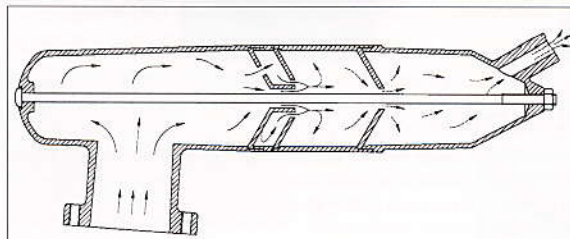

Code No.	Type	Type of Engine
22325030	E-2030S	20-25FP
23325030	E-3030S	35-40FP, 40-46LA, 32SX
26028010	E-4010S	61FX, 65LA
25425020	873S	40-46FX

UNIVERSAL SILENCERS



O.S. Universal Silencers are suitable for many types of models, including boats and cars, since they can be installed inside the model if adequately cooled or isolated. Distance from the engine can be extended to suit required location and the exhaust outlet rotated to any desired position.

Code No.	Type	Type of Engine
72110000	881	10-15LA CV SERIES
72111000	882A	20-25FP
72112000	882B	25FX-SF
72113000	883	32SX

SILENCER EXTENSION ADAPTORS

For O.S. side-exhaust two stroke engines, these are designed to distance the standard silencer body from the engine so that it does not touch the fuselage.



Code No.	Type of Silencer
21125108	761-871
22625103	762-892
25425600	873
22325100	E-2030-842
23325100	E-3030-843-762S
26625340	744B-E-4010



EXHAUST ADAPTORS

For O.S. side-exhaust two stroke engines, these allow the silencer to be rotated through 90 degrees (e. g. for some helicopter installations.)



Code No.	Type of Silencer
21125502	761-871
22625508	E-3030-762-892
24925419	743
26625403	744
26625410	744B-E-4010

EXHAUST ADAPTORS

For O.S. side-exhaust two stroke engines, these allow the silencer to be rotated through 90 degrees (e. g. for some helicopter installations.)

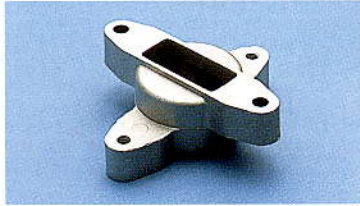

Code No.	Type of Silencer
21125502	761-871
22625508	E-3030-762-892
24925419	743
26625403	744
26625410	744B-E-4010

EXHAUST HEADER PIPE 52S (IN-COWL)



For FS-52S
(72108400)

EX EXHAUST HEADER PIPES



Inside fuselage
For FS-120S-E,S III
(72109200)
FS-70S,91S
(72109500)



Outside fuselage
For FS-120S-E,S III
(72109300)
FS-70S,91S
(72109600)

FLEXIBLE EXHAUST PIPES



Semi-flexible exhaust pipes of different sizes, for use with or without silencers, are available for single, twin and multi-cylinder four-stroke engines.

Code No.	Type	Type of Engine	Length
72108300	1010A	FS-40-52S	120
72108310	1010B	FS-40-52S	240
72108000	1011A	FR5-300	120
72108010	1011B	FR5-300	240
72108100	1111A	FS-70-91S	120
72108110	1111B	FS-70-91S	240
72108120	1111C	FS-70-91S	170

Code No.	Type	Type of Engine	Length
72108130	1111D	FS-70-91S	330
72108200	1114A	FT-300	120
72108210	1114B	FT-300	240
72108230	1114C	FT-300	170
72108240	1114D	FT-300	330
72108510	1414A	120S III	120
72108520	1414B	120S III	240
72108201	A	FS-120S-SP,SE	120
72108211	B	FS-120S-SP,SE	240

EXHAUST COLLECTOR RINGS

Exhaust collector rings for the FR5-300 four-stroke radial engine are available in two types: one for front installation and the other for fitting behind the cylinders.



Front installation
(47069000)



Rear installation
(47069010)

EXHAUST HEADERS



Water Cooled

Code No.	Type of Engine
25326600	40-46VR-M 46VX-M
27126400	61-65-81VR-M

Code No.	Type	Type of Engine
22826100	No.1 -20"	21RG SERIES
22826110	No.2 0"	21RG SERIES
22826120	No.3 12"	21RG SERIES
22826130	No.4 0"	21RG SERIES
22426207	0"	32F

Code No.	Type	Type of Engine
25326101	(401) 7"	40-46VR 46VF
25326110	(402) 12"	40-46VR 46VF
25326130	(404) 0"	40-46VR 46VF
27126306	10"	61VR~91VR
27126109	5"	61VR~91VR
29025507		108FSR (BX-1)

O.S. SILICONE TUBE ASSEMBLY



Available in three sizes for connecting two-stroke engine header pipe to tuned silencers, these are heavy-duty heat-resistant moulded silicone-rubber connectors, each with two clips.

(72105337) 40~46 φ15
(72101338) 61~91

(72102300) BGX-1

T-4010 TUNED SILENCER

(72101120) For 61FX

T-6010 TUNED SILENCER



- Specifically designed and developed for the 23cc O.S. MAX140RX World championship class R/C aerobatic engine.
 - Precisely matched to the performance characteristics of the MAX-140RX - i.e. high performance at lower r.p.m. of between 7,000 and 8,000.
 - Latest design to further reduce noise level.
- (72104200) For 140RX 140RX-FI

T-6000 TUNED SILENCER



The T-6000 tuned silencer and its matching header pipe were developed for the 35cc MAX BGX-1. So equipped, the BGX-1 will deliver 30-40% greater power, in the favoured 7,000-8,000 r.p.m. range, than when fitted with the standard E-5010 silencer.

(72102000) For BGX-1

T-1020 TUNED SILENCER



O.S. SPEED
This new tuned silencer is for the MAX 10FP-B and CV-LD Series car engines. Double-chamber design offers high performance and low noise emission. A blue-anodized surface treatment, as used by the T-2010 and T-2020, is featured.

(72103020) For 10FP-B-BX, CV-LD Series

T-1010 TUNED SILENCER



O.S. SPEED
This has been designed specifically for 2.5cc 1/10th scale racing car engines. The black anodized body matches the crankcase of the MAX-15RX.

(72103010) For 15RX

T-2030 TUNED SILENCER



O.S. SPEED
The new T-2030 is the latest heavy-duty O.S. tuned silencer for high-performance 3.5cc car engines and is approved by FEMCA. The T-2030 achieves power increase at the entire r.p.m. range. It has an all-over blue anodized surface treatment for added durability. This replaces the former T-2020 tuned silencer.

(72106030) For 21Car Engines

F-2000 4C CAR SILENCER

O.S. SPEED



(44125100) For FS-26S-C/26S-CX

SUPER JOINT TUBE

O.S. SPEED



This is the ultimate super heat resistant silicone joint tube.

15 (72103310)
For 12,15CV-CV-X, 12,15LD-LD-X 15RX



21 (72106300)
For 21 Engines

EXHAUST HEADER PIPES For use with tuned silencers.



For 61-91FX
(72101230)



For BGX-1
(72102200)



For 140RX, RX-FI
(72102100)



For 46VX-M
(72101260)



For 12/15CV-CV-X
(72103110)
For Kyosho Super10



For 12/15CV-CV-X
(72103130)
For Tamiya TG10



For 15RX
(72103210)



For 12/15CV-CV-X
(72103140)



For 21RG-X
(72103510)



For 21RZ-V99b/99b(P)
(72101270)



For 12/15CV-CV-X
(72103120)



HYPER EXHAUST
For FS-26S-C/CX
(44126000)



HYPER EXHAUST
For FS-26S-C/CX
(44126010)

For Tamiya TGX

10A AUTOMATIC CARBURETTOR

O.S. SPEED



This slide-throttle carburettor has been designed expressly for the CV-CZ series car engines. It releases their full potential, providing instant throttle response, rapid acceleration and high peak power output.

(21285001) For 12CV-CV-X Series

SUPER AIR CLEANERS

O.S. SPEED

These efficient 'wet' type air cleaners, expressly designed for O.S. model car engines.



101 (72403100)
For 10FP-B-BX, FS-26S-C-CX



102 (72403200)
For 12,15CV-CV-X



102S (72403202) 103 (72403300)
For 12,15CV-CV-X For 15RX



201 (72411000)
For 21 OFF-ROAD CAR ENGINES



202 (72412000)
For 21 TRACK-RACING CAR ENGINES

FILTER ELEMENT

101, 102 (72403120) For FP, CV, FS-26S-C 104 (72403420) For LD-LD-X
103 (72403320) For 15RX 201 (72411020) For 21RG, RZ-B, V99b
202 (72412200) For 21RZ-R

E-1000 SILENCER FOR 12LD/LD-X FOR TAMIYA TGX, TG10 CAR

O.S. SPEED

The E-1000 Silencer is designed to fit the 12,15LD/LD-X engines in TAMIYA TGX model cars.



(21325000)
For 12,15LD/LD-X

BUBBLELESS WEIGHT

This is a new, improved type of fuel pick-up weight which prevents air bubbles,



(71531000)

generated by engine vibration, from reaching the carburettor and causing the engine to malfunction or stop.

- It is plated throughout to prevent corrosion and the nipple and weight are bonded together to eliminate any risk of their coming apart.
- A silicone-rubber O-ring surrounds the 'Bubbleless' pick-up weight to prevent internal damage to the tank.

SUPER FILTERS



S (72403051)
L (72403050)

Minute particles of foreign matter are invariably present in unfiltered fuel reaching the carburettor, causing obstruction, erratic running and the risk of damage. An in-line filter between tank and engine is helpful, but the first requirement is for the fuel to be filtered before it reaches the tank. An O.S. Super-Filter, fitted inside your refueling container, is the ideal solution.

CRANKSHAFT CLAMP



This device facilitates the installation, or removal, of a flywheel, cooling-fan or pilot shaft, by temporarily locking the crankshaft so that it cannot rotate. Made of durable engineering plastic, it achieves this without risk of damage to any part of the engine and can also be used with recoil-starter equipped engines.

Code No.	Type	Type of Engine
71530100	1012	10FP-B 12,15CV SERIES
71530200	1521	21RZ-RG 12,15CV 15RX
71530400	3246	32SX-H 46FX-H
71530300	3261	32F-H-SX-H 61SX-H-RX-H-LX-H

DETACHABLE HEX-WRENCH SET



This consists of a socket wrench and four hexagon keys (1.5, 2.0, 2.5 and 3.0mm) for use with socket-head screws. Each key is firmly gripped by the wrench.

(71525000)

LONG SOCKET WRENCH WITH PLUG GRIP



This special glowplug wrench is for use with cowed engines or those having deep heatsink type heads (e.g. car and helicopter motors). It has an internal grip which holds the plug securely while it is being withdrawn or reinserted.

(71521000)

DUST CAP SET

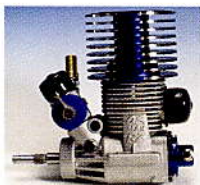

Code No.	Type	Quantity
73300305	#4 DUST CAP	5PCS.
73300712	#7 DUST CAP	3PCS.
73300812	#8 DUST CAP	3PCS.
73301012	#10 DUST CAP	3PCS.
73301212	#12 DUST CAP	3PCS.
73301612	#16 DUST CAP	3PCS.
73301812	#18 DUST CAP	3PCS.

VALVE ADJUSTING TOOL KIT



The kit comes in a plastic case and includes:

- Feeler gauge 0.04mm
- Feeler gauge 0.1mm
- Hex. key 1.5mm
- Wrench 5mm
- Screwdriver (72200060)

TAP SETS



- M2.6 (72901000)
- M3.0 (72901001)
- M3.5 (72901002)
- M4.0 (72901003)

BLIND NUTS (10pcs./set)



- M3 (79870030)
- M4 (79870040)
- M5 (79870050)

LOCK WASHER (10sets)



This is a very effective lock-washer.

- M3 (55500002)
- M5 (55500004)
- M4 (55500003)
- M6 (55500005)

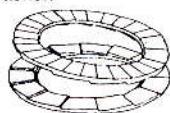

DRIVE HUB

Code No.	Type of Engine
23908000	21RG-RG (P)
23408000	32SX-H-HX

SILENCERS

Code No.	Type	Type of Engine
21225000	871	10-15FP 10-15LA CV SERIES
22325020	E-2030	20-25FP 25LA
23875000	E-2050	21XM
22628000	892	25FX 25SF 32F SERIES
23325020	E-3030	35-40FP 32F SERIES 32SX SERIES 40-46LA
22625040	762S	35-40FP-S
25425000	873	40SF46SF SERIES 40-46FX SERIES
26028000	E-4010	60FP 61FX 65LA
29525000	E-4020	91FX
29025000	855	108FSR (BX-1)
29325000	E-5010	BGX-1 160FX
44125000		FS-26S
45725010	Q.T.	FS-26S
45225000		FS-40S
44225000	F-3020	FS-52S
45925000		FS-70S-91S
45925010	F-4020	FS-91S II-SII-P
45525001		FS-120S SERIES
45525030	F-5020	FS-120 III
41635010		ROTARY 49-PI

CARBURETTORS

Code No.	Type	Type of Engine	Remarks
21381000	1A	10FP-M-MX	○
21081000	10H	10LA	●
21381020	1AB-K	10FP-B-BX	●
21381050	1AB-K6	FS-26S-C	●
21283011	2BK	CZ-R-RX-1-2	●
21285002	10A	CZ-R-RX-12Z-12ZX 12.15CV-CV-X	●☆
21481010	10E	12.15CV-CV-X-15CV-M/MX	●
21183000	10F	12.15LD-LD-X	●☆
21881000	10D	15RX	●☆■
21783000	10G	15LA	●
21781000	15	15FP	○
22381000	2A	20FP-M 25FP	○
22481045	2D	21SE-M 21EX-M 21RX-M	●
23618001	20E	21RG 21RG (P) 21RG-X 21RG (P)-X	●☆
23482000	20F	32SX	●
25382000	20J	21XM	●
23881000	20G	21RZ-M	●
23818001	20A	21RZ-R (P) 21RX-R (P)	●☆■
23818030	20B	21RZ-B-B (P) 21RX-B (P) 21RZ-V99b-V99b (P)	●☆■
22581000	20H	25LA	●
22681030	20D	25FX	●
22981000	3H	32F-H-HS-HX	●
23481000	20C	32SX-H-HX	●
23381000	3A	35-40FP	○
25581000	40A	46VX-M	●
25681000	40B	40-46FX	●
24081000	40D	40-46LA	○
25683000	40C	46FX-H	●
25281000	40E	50SX-H	●■
25381006	4D	40-46SF 46SF-H-HS 40-46VF 46VF-H	●
25383010	4E	21RX-M 40-46VR-M 46VR-DF	●
27982000	60G	61LX-H	●
27982010	60H	61LX-H LX-HGL	●
26029000	60A	60FP	○
27783000	60C	61FX	●
26581000	60J	65LA	●
26181000	6B	61SFN-H-RFN-H	●
27882010	6P	HANNO SPECIAL-HANNO SPECIAL II	●△
27981010	60B	61RX-H-SX-H	●■
29381010	9B	61-81VR-M 65VR-DF 91VR-DF	●
29581000	60F	91FX160FX	●
29081010	7D-RN	108FSR (BX-1)	●
29481000	70A	140RX	●△
29383010	8AA-RN	BX-1	●
45281010		FS-26S	○
45281020		FS-40S	○
44281000	40N	FS-52S	●
44081000		FS-70S	●
45981000		FS-91S	●
45983000	60N	FS-91S II-P	●△
45583010	C12	FS-120S	●△
45581000		FS-120S-E	●
45582000	70C	FS-120S III	●△
45586001	C14	FS-120S-SP	●△
46181000		FT-240 II (Gemini II) FT-160 (Gemini160)	○
46281000		FT-240 (Super Gemini)	●
		FT-300 (Super Gemini300)	●
46481000		FF-240 (Pegasus) FF-320 (Pegasus320)	●
47081000		FR5-300 (Sirius)	●
41618020	49PI-RN	ROTARY 49-PI	●

- ...Air Bleed type ●...Fuel metering type
 △...For use with pump □...W/medium speed range mixture adjustment
 ★...W/return spring ☆...Slide-throttle type
 ■...W/Thermo-insulator

Weight Of Silencer Supplied With Engine(Incl. Fitting Screws)

Engine	Silencer	Weight(g)
BGX-1	E-5010	310
160FX	E-5010	310
108FSR	855	254
91FX	E-4020	190
61FX	E-4010	149
46FX	873	126
40FX	873	126
32SX	E-3030	83
25FX	892	62
15CV-A	871	40
65LA	E-4010	149
46LA	E-3030	83
40LA	E-3030	83
25LA	E-2030	65
15LA	871	40
10LA	871	40
46LA-S	E-3030	83
40LA-S	E-3030	83
25LA-S	E-2030	65
15LA-S	871	40
R.E.		33.4
FS-120S III	F-5020	79.5
FS-91S II Series	F-4020	47
FS-70S II	F-4020	47
FS-52S	F-3020	29
FS-48S		23.3
FS-26S		11

O.S. ENGINE
 UNEQUALLED QUALITY PRECISION & PERFORMANCE

Due to updating and improvement, latest products may occasionally differ from those shown in the photos. All the specifications shown in this catalogue are subject to change without notice.



O.S. genuine glow plugs that generate highest performance from O.S. engines.

How Glowplug Ignition Works

With a glowplug engine, ignition is initiated by the application of a 1.5-volt power source. When the battery is disconnected, the heat retained within the engine's combustion chamber remains sufficient to keep the engine running. Ignition timing is 'automatic': At higher rpm, the plug becomes hotter and, appropriately, fires the fuel/air charge earlier; at reduced rpm, the filament becomes cooler and ignition is retarded.

Glowplug Life

Particularly in the case of very high performance engines, glowplugs have to be regarded as consumable items. However, plug life can be lengthened and performance maintained as follows:

- Fit a plug suitable for the engine.
- Use fuel containing a moderate percentage of nitromethane unless essential for contest use.
- Do not run the engine lean, or leave the plug connected while adjusting the needle-valve.
- Use a fuel containing as low nitro as possible.

When to replace the Glowplug

Apart from when actually burned out, a plug may need to be replaced because it no longer delivers its best performance, such as when:

- Filament coil has become distorted.
- Filament surface has roughened/turned white.
- Foreign matter had adhered to filament or plug body has corroded.
- Engine tends to cut out when idling.
- Starting qualities deteriorate.

How to select a suitable glowplug in each category.

For R/C Cars

Type A3

Running-in, For beginners (rich needle setting)
Engine types: 10FP-B, CZ Series, 12CV and 12LD



Type No.8

General use, 1/8 Off-road racing
Engine types: CZ Series, 12LD, 21RG and 21RZ-B

Type A5

1/8 Off-road racing, 1/10 Circuit racing, 12 class GP touring racing
Engine types: 21RG, 21RZ-B, CZ Series, 12CV and 12LD

Type R5

1/10 and 1/8 Circuit racing
Engine types: 15RX and 21RZ-R

For R/C Aircraft

Type A3

Running-in, Engines smaller than .32 capacity
Engine types: 25SF, 25FX, 10-40FP, 40&46LA,



Type No.8

General purpose
Engine types: Most O.S. engines

Type A5

Larger than .60 capacity engines
Engine types: 6IFX, 140RX, BX-1, and BGX-1

For R/C Helicopter

Type A3

Running-in, Smaller than .32 capacity engines (for beginners)
Engine types: 32F-H and 32SX-H



Type No.8

General purpose
Engine types: Most O.S. engines

Type A5

With higher nitro fuel, to reduce overheating
Engine types: All O.S. helicopter engines

For Four-Stroke Engines

Type F

Engine types: All Four-stroke engines

For O.S. Wankel Rotary Engines

Type RE

Engine types: Expressly for O.S. rotary engine 49PI



A3



A5



R5

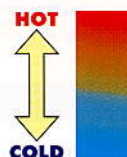

Type	Cord No.
A3	71605300
No.8	71608001
A5	71605100
R5	71605200
F	71615009
RE	71614001

Due to updating and improvement, latest products may occasionally differ from those shown in the photos. All the specifications shown in this catalogue are subject to change without notice.

O.S. LIVE STEAM LOCOMOTIVE

The combination of half-a-century of experience in precision model engineering, the application of special O.S. technology and the use of modern computer controlled machinery, was responsible not only for the O.S. company becoming the world's largest producer of quality model engines; it also laid the foundations of another remarkable achievement: the design and manufacture of superb live steam scale locomotives. These are available as sets of precision-made parts. Some components, such as the boiler, are, in the interests of safety, ready built and tested. Also in the interests of safety and reliability, these powerful locomotives are extensively tested during development and, for this, the company has its own half-mile factory test track. All essential equipment to establish a complete railroad system is available from O.S. including track, scale rolling stock, passenger riding cars and numerous parts and accessories. All this equipment is manufactured to meet the highest standards of durability and safety.

KRAUSS 0-4-0

This fascinating little model of the German Krauss 0-4-0 is a vigorous performer and has outstanding power for its small size.

Gauge of track3-1/2" (89mm)
Weight : Engine36lbs. (16.5kg)

Size : Length19.1in. (485mm)
Width 7.1in. (180mm)
Height11.0in. (280mm)
Options : Chimney, Headlight, Dummy whistle.

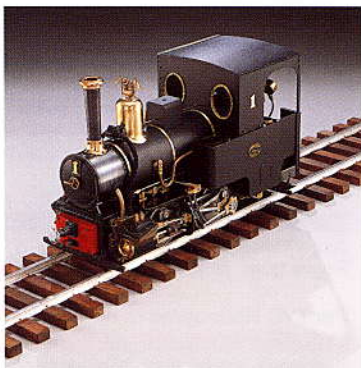

KOPPEL

The full-size prototype of this engine was a narrow gauge locomotive built by Orenstein & Koppel and delivered to the Igasa Railway Company in 1913. The O.S. KOPPEL is a faithful replica of this veteran loco, accurately scaled down to one-seventh full size. The open deck type cab is conveniently "user-friendly" for the driver and the side tanks, plus a bottom tank located within the main frame of the engine, contain sufficient water, aided by a new type of feed pump, to run the engine for over 2km non-stop. A range of optional accessories and scale parts is available to optimize the character of this new addition to the incomparable O.S. range of live steam locomotives.

Gauge of track4-3/4" or 5" (127mm)
Weight : Engine94.8lbs. (43kg)
Size : Length30.3in. (770mm)
Width 9.1in. (230mm)
Height17.3in. (440mm)

Options : Donkey pump,
Injector, Turbo generator,
Propane burner,
Accessories parts



PORTER 2-6-0

The Porter 2-6-0 Mogul Class loco was used on the railroads that opened up the American West in the nineteenth century. Our model is a handsome reproduction of this famous engine built by Porter Locomotive Works of Pittsburg in 1880. The model is impressively complete and has running gear that is authentic in every detail.

Gauge of track3-1/2" (89mm) Size : Length41.3in. (1,050mm)
Weight : Engine38.6lbs. (17.5kg) Width 6.9in. (175mm)
Tender18.5lbs. (8.4kg) Height11.8in. (300mm)



JNR TYPE C11

In 1830, the world's first inter-city railroad for passengers and freight was established in England between Liverpool and Manchester and the locomotive chosen to haul those trains was the legendary 'ROCKET' designed by George Stephenson. Now, to complement the unsurpassed O.S. range of live steam replicas of famous locomotives from around the world, we have introduced this 5-inch gauge model of the original 'ROCKET'. Built to a scale of 1/11.3, this superb model incorporates all the major features of the original engine, including its wooden-clad multi-tube boiler, with separate water-jacketed firebox, its authentic Stephenson valve gear and its inclined outside cylinders coupled directly to the driving wheels.

Gauge of track4-3/4" or 5" (127mm) Size : Length23.6in. (600mm)
Weight : Engine19.8lbs. (9kg) Width 7.3in. (185mm)
Tender 6.6lbs. (3kg) Height16.7in. (425mm)

Options : Propane burner (for Rocket), First-class passenger car (for Rocket),
Third-class passenger car (for Rocket), Portable tracks (3.8m radius),
Display track.

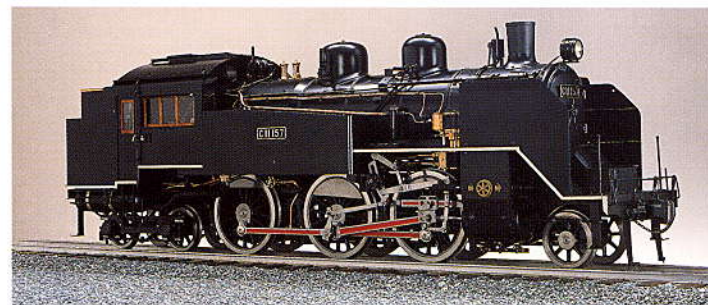

BRITANNIA 4-6-2

This is a scale model of the celebrated Britannia class BR7 locomotive which, introduced in 1951, was the last steam locomotive designed for express passenger service in Britain.

The model's balanced 4-6-2 wheel arrangement and superb detail faithfully reproduce the beautiful movement of this fine loco. Its noble lines recall the opulence of first-class rail travel in Europe's golden age of steam.

Gauge of track3-1/2" (89mm) Size : Length52.4in. (1,330mm)
Weight : Engine90.4lbs. (41kg) Width 7.5in. (190mm)
Tender22.0lbs. (10kg) Height10.6in. (270mm)
Options : Donkey pump, Injector, Steam brake, Dummy parts



T5-SUPER 0-6-0

This is an inch scale model of the most popular Japanese tank locomotive.

The model is highly detailed and also a great performer.

Gauge of track3-1/2" (89mm) Size : Length41-15/16" (1,065mm)

Weight : Engine110lbs. (50kg) Width9-1/8" (232mm)
Height13-13/32" (341mm)

Options : Side tank, Three-note steam whistle,
Donkey pump, Turbo generator



SUPER-6 0-6-0

The T-5 is an original O.S. design based on a typical British tank engine. It is perfect for those live steam enthusiasts who desire a powerful, easy to operate locomotive. It has tremendous endurance and pulling power for a 1" scale locomotive. Other features include a two-note whistle, large easy to read pressure gauge, easy to control throttle and spacious cab.

Gauge of track4-3/4" or 5" (127mm) Size : Length37.0in. (940mm)

Weight : Engine157lbs. (71kg) Width12.2in. (310mm)
Height15.3in. (390mm)

Options: Donkey pump, Steam brake



ROCKET

This is an original O.S. designed American style tender locomotive. It features Baker valve gear to deliver high power and endurance.

It has all the features of the T-5 Super plus the option of an electric generator, steam water pump and injector.

The padded driver's seat and footrests are on the tender for ease of operation and driver comfort.

Gauge of track : 4-3/4" or 5" (127mm)

Weight : Engine146lbs. (66kg)
Tender 64lbs. (29kg)

Size : Length62.2in. (1,580mm)
Width12.2in. (310mm)
Height15.4in. (390mm)

Options : Steam water pump,
Turbo generator,
Injector



FOUR TRUCK SHAY

At its nickname ('Hercules of the Forest') suggests, the Shay locomotive is famous for its role in American forestry. Its unique design, with all wheels being driven by a drive shaft and bevel gears, enabled it to run along tight radiuses and uneven track found in forestry operations. O.S. has reproduced the Shay true to the original, but and has added a fourth driven truck underneath the operator's weight to enable this model to deliver tremendous tractive effort. In addition to its high power, it is smooth running and easy to control. All who see this wonderful model are fascinated by its design and construction.

Gauge of track : 4-3/4" or 5" (127mm) Size : Length65.0in. (1,650mm)

Weight : Engine150lbs. (68kg) Width10.2in. (260mm)
Tender 71lbs. (32kg) Height15.0in. (380mm)

Options : Steam water pump, Turbo generator, Injector



MOUNTAIN 4-8-2

This magnificent model is of the USRA Heavy Mountain Type loco built by Alco: one of the all-time great steam locomotives. No compromises have been made in the design or manufacture of this O.S. masterpiece. Wheel slippage is virtually eliminated through the employment of a drive-shaft and gearbox to all eight tender wheels, which are beneath the driver's weight. This is, indeed, a phenomenal model for the enthusiast who demands the ultimate in live-steam.

Gauge of track : 4-3/4" or 5" (127mm) Size : Length83.7in. (2,227mm)

Weight : Engine230lbs. (100kg) Width10.6in. (270mm)
Tender 93lbs. (42kg) Height15.7in. (400mm)

R.T.R. comes with Injector, Steam brake, Turbo generator and Westinghouse air compressor type steam water Injector



HINKLEY 2-4-0

Gauge of track7-1/2" (190.5mm) TenderWeight110.3lbs. (500kg)

EngineWeight661.5lbs. (300kg) Length55.1in. (1,400mm)

Length65.4in. (1,660mm) Width18.5in. (470mm)

Width22.0in. (560mm) Height14.2in. (360mm)

Height34.1in. (867mm)

Options : Steam water pump, Injector Propane burner set, Suction fan complete kit



Colors of photographs shown here may differ a little from those of actual locomotives.

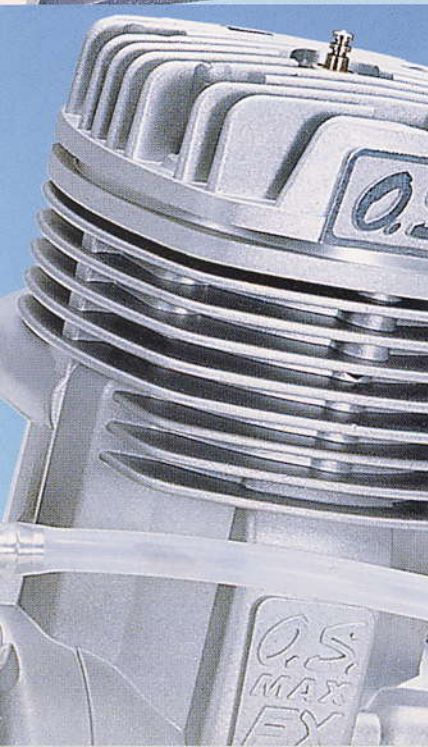

O.S. ENGINE

Unequalled Quality Precision & Performance

O.S. ENGINES MFG. CO. LTD.

6-15, 3-Chome Imagawa Higashisumiyoshi-ku Osaka 546-0003 Japan
TEL (06) 6702-0225 FAX (06) 6704-2722

© Copyright 1999 by O.S. Engines Mfg. Co., Ltd. All rights reserved. Printed in Japan